

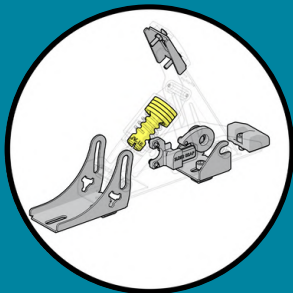

Assembly manual

LogiKIT

Power up your Logitech Pedals

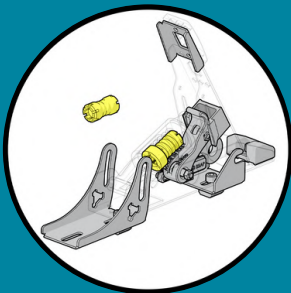
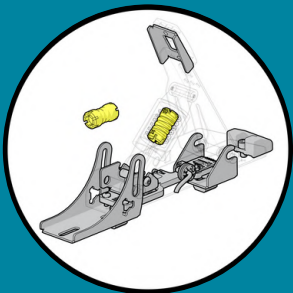



Summary

Notes.....	2
Brake pedal assembly.....	3
Clutch pedal assembly.....	6
Throttle pedal assembly.....	11
Accessories.....	15
Pedals installation on generic base plate.....	16
Pedals installation on nGASa GT base.....	17



Notes

- Redundant components will be tagged once in the following illustrations to simplify the representation;
- The list of components of each pre-assembled is indicated.

Brake pedal assembly



**1 x SL053_01AP
(Load cell chassis)**

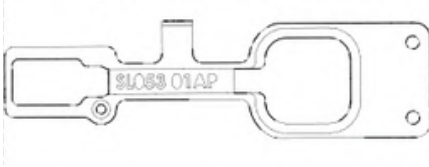

**1 x M5x30
female
spacer**



**2 x M3
socket
head
cap
screw**



**2 x M5
button
head
screw**



**2 x M3
button
hex
nut**



1 Load cell

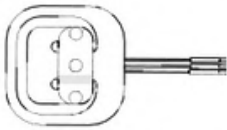

1 Load cell amplifier



**1 x SL053_05SM
(Load cell presser)**



**1xACC001_13AF
(cable elastomer)**



**1 x SL053_07SM
(front support)**

**1 x SL053_08SM
(rear support)**

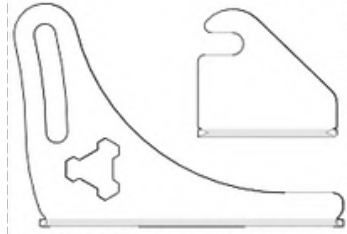

**1xSL053_02AF
(Hard elastomer)
OR 1xSL053_03AF
(Medium elastomer)**



Load cell cable

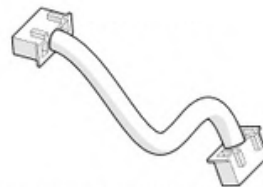

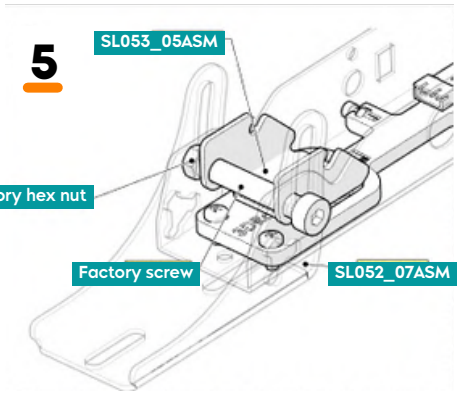
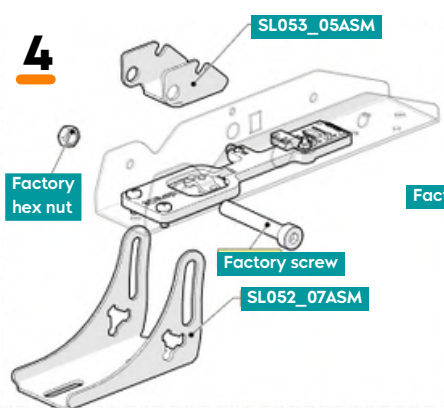
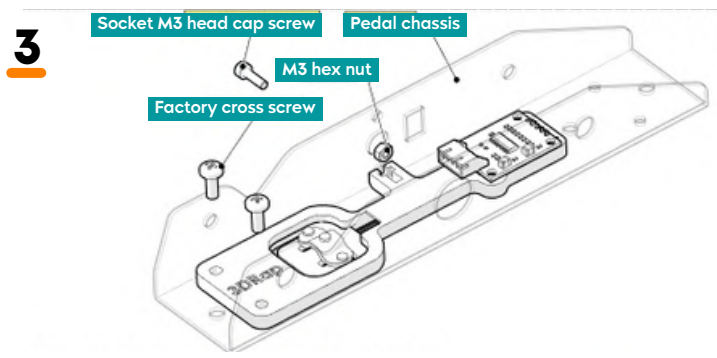
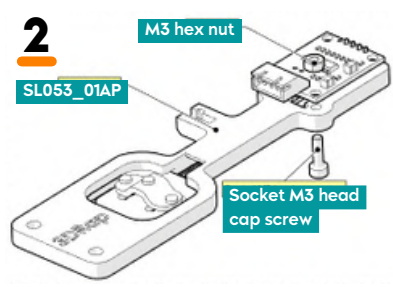
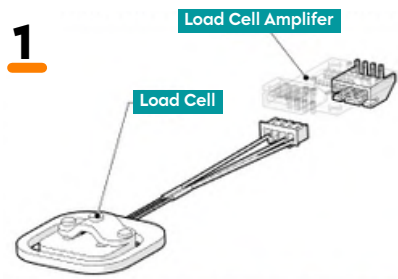

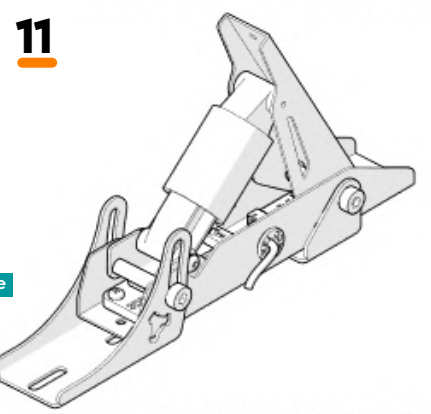
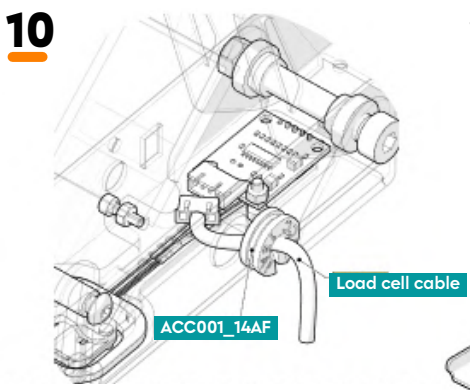
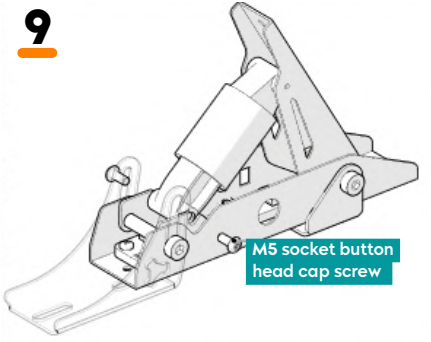
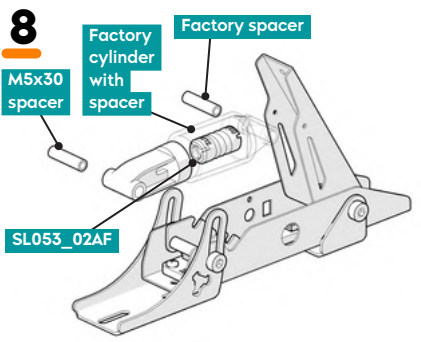
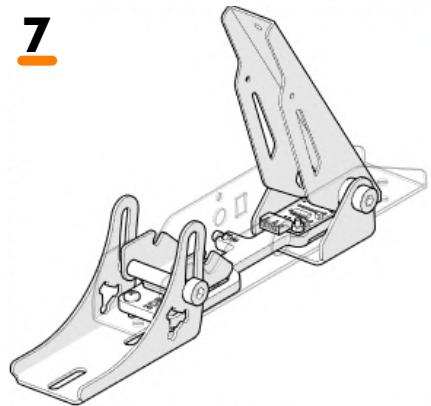
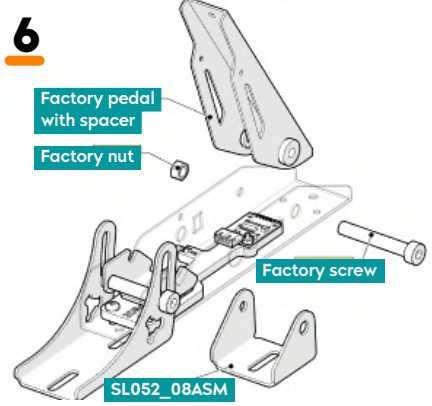



Clutch pedal assembly

2 x M5x10
spacer
without
thread



2 x M3
socket
head cap
screw



1 x M5 socket
countersunk
head screw



2 x M3
hex
nut



1 x M5
hex
nut



5 x M5
flat
washer
narrow



1 x M6
flat
washer
narrow



1 x
SL052_02AP
(Hall sensor
housing)

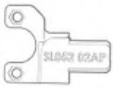

1 x
SL052_03AP
(Hall sensor
cover)



1 x
SL052_04AP
(Magnet with
housing)



1 x
SL052_06AP
(Slide
support)



1 x
SL052_05AF
(Slide for
bearing)



1 x SL052_01AP
(Rotating rod
assembly with
bearings)



1 x SL016AP



1 x SL053_07SM
(front support)

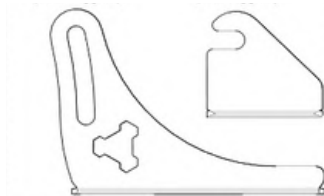

1 x SL053_08SM
(rear support)

1 x Hall sensor cable





1

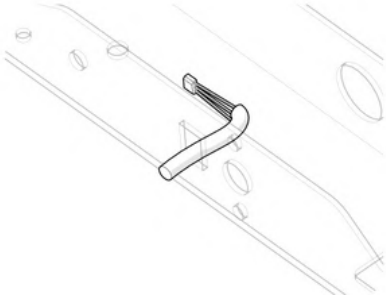

2

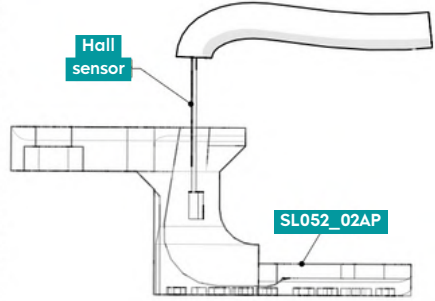

3

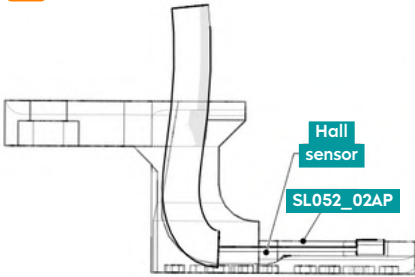

4

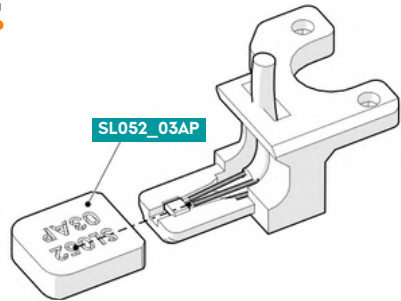

5

Socket M3 head cap screw

M3 hex nut

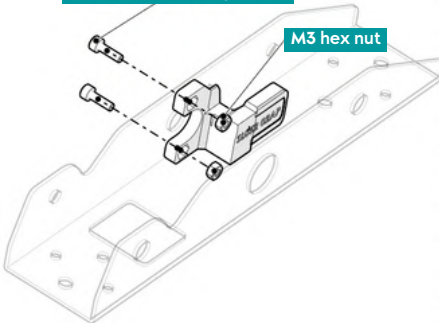

6

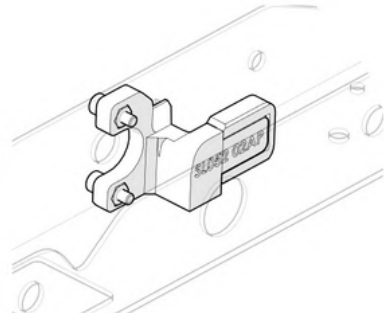



7

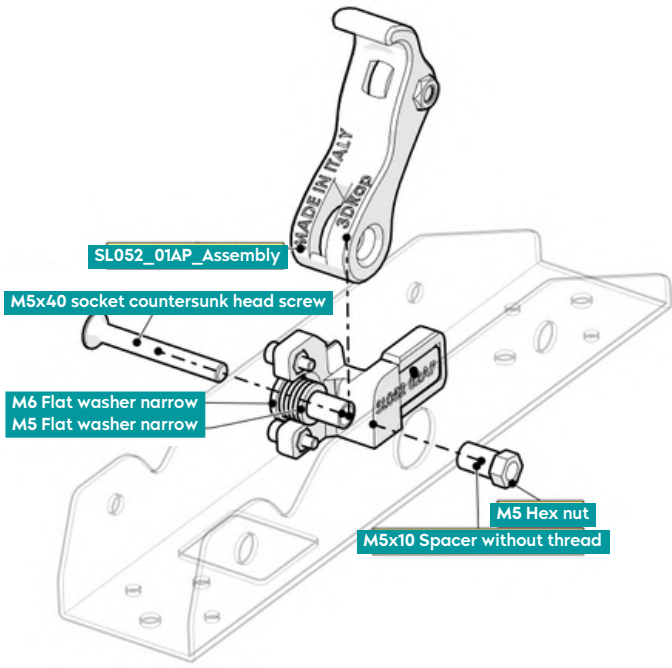

8

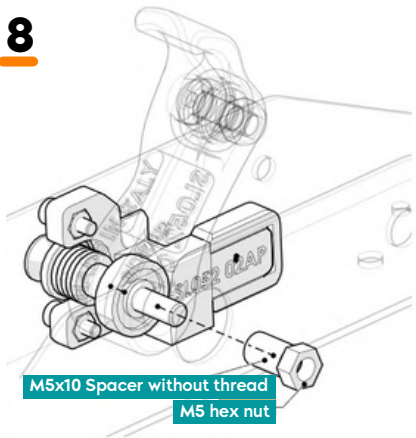

9

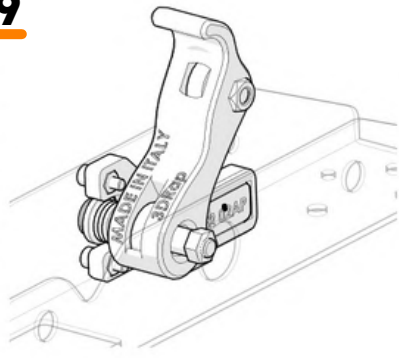



10

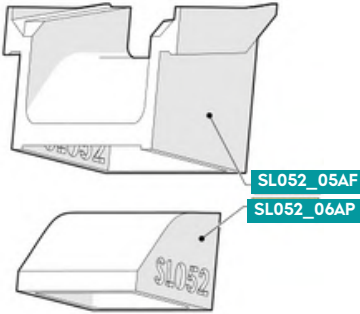

11

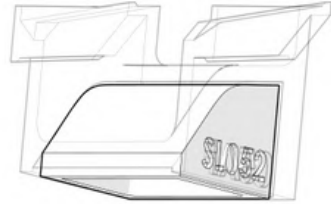

12

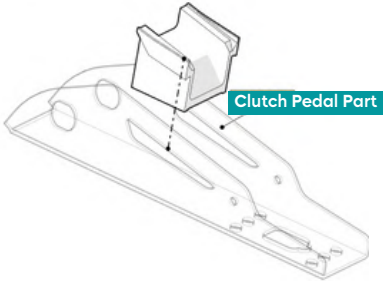

13

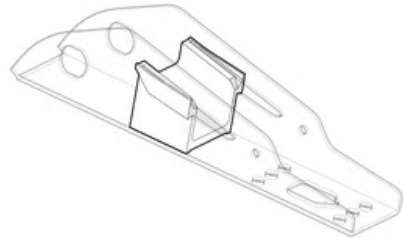

14

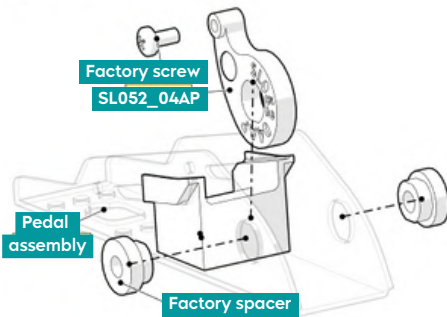

15

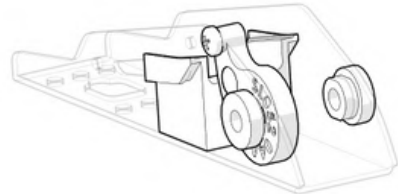



16

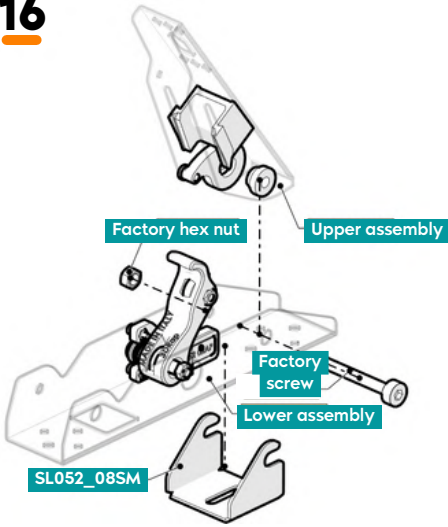

17

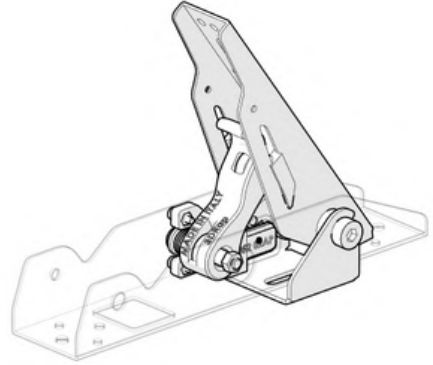

18

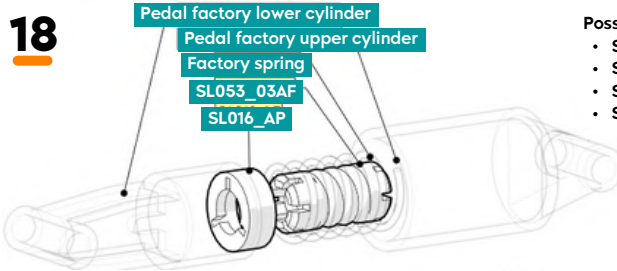

Possible couplings with factory spring:

- SL053_02AF
- SL053_02AF+SL016AP
- SL053_03AF
- SL053_03AF+SL016AP

19

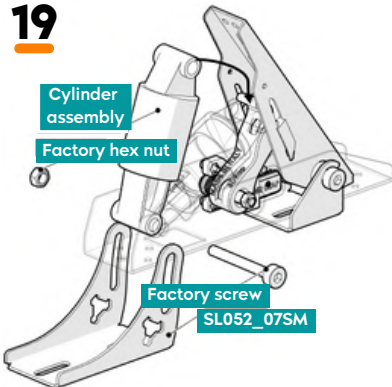

20

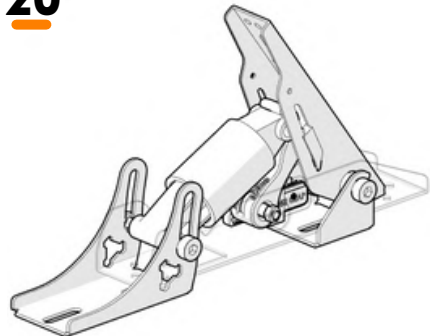



Throttle pedal assembly

2 x M3
socket
head cap
screw



2 x M3 hex
nut



1 x
SL052_02AP
(Hall sensor
housing)

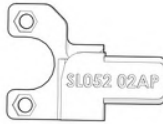

1 x
SL052_03AP
(Hall sensor
cover)



1 x
SL052_04AP
(Magnet with
housing)



1 x SL055_01AF
(Throttle
elastomer)



1-4 x SL055_02AF
(Throttle
excursion
spacer)



1xSL053_07SM
(front support)

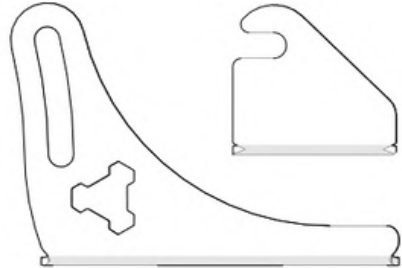

1xSL053_08SM
(rear support)



1 x Hall sensor cable with grounding loop

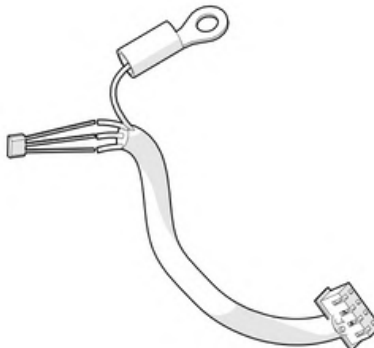



1

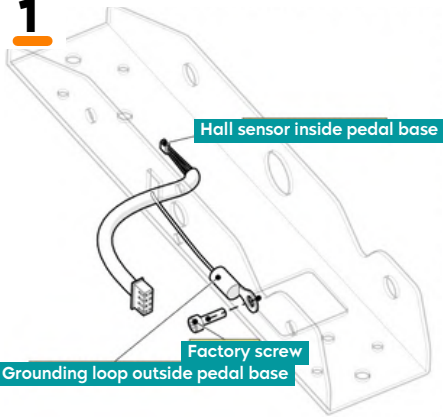

2

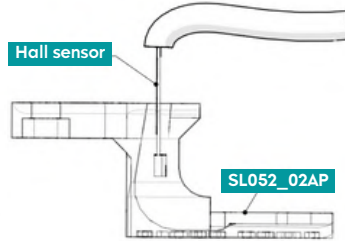

3

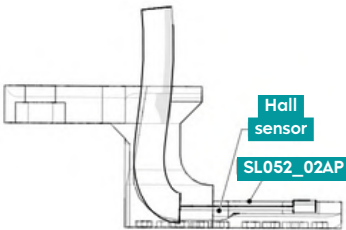

4

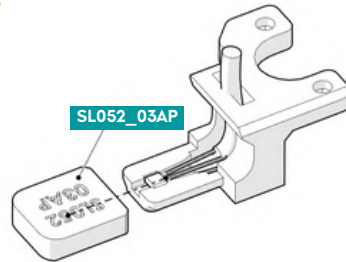

5

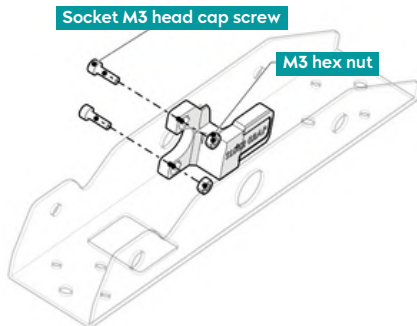

6

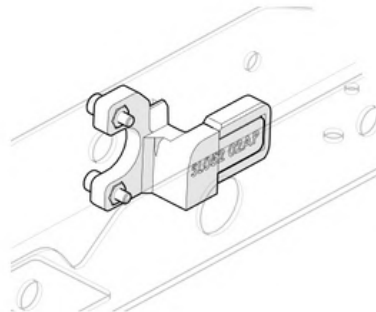



7

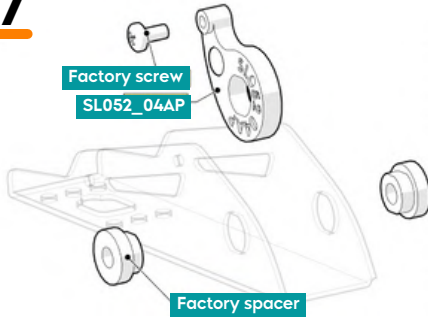

8

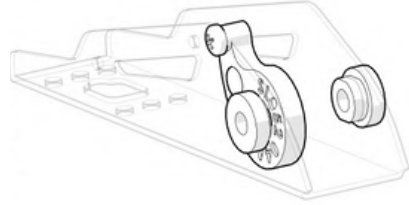

9

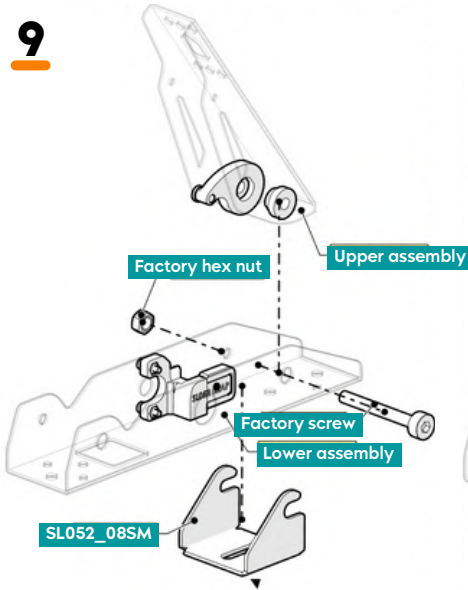

10

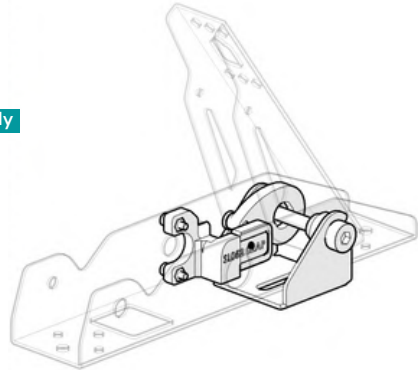

11

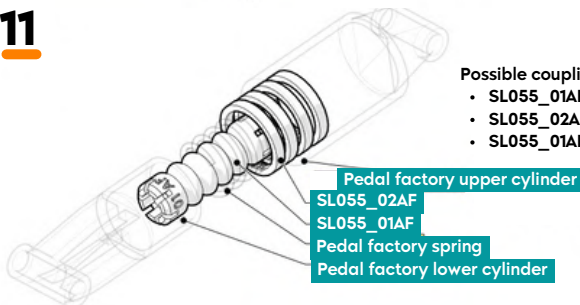

Possible couplings with factory spring:

- SL055_01AF
- SL055_02AF (from 1 to 4 spacer)
- SL055_01AF + SL055_02AF (from 1 to 4 spacer)



12

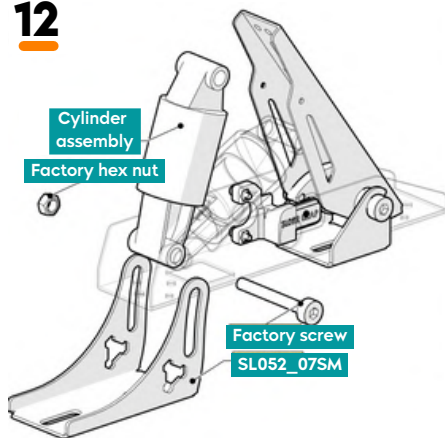

13

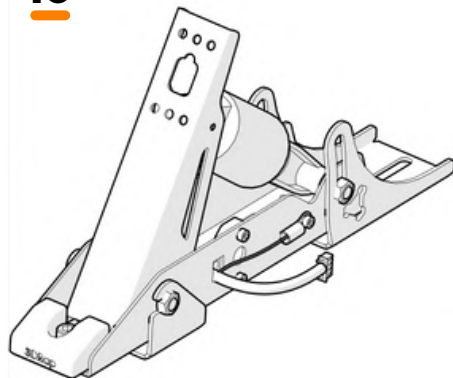



Accessories

**3xSL052_10ASM
(pad extension)**

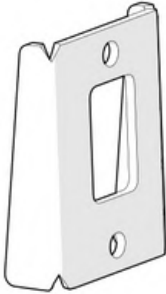

**3xSL052_09AP
(heel rest)**



**3xM6 socket
head cap screw**



1

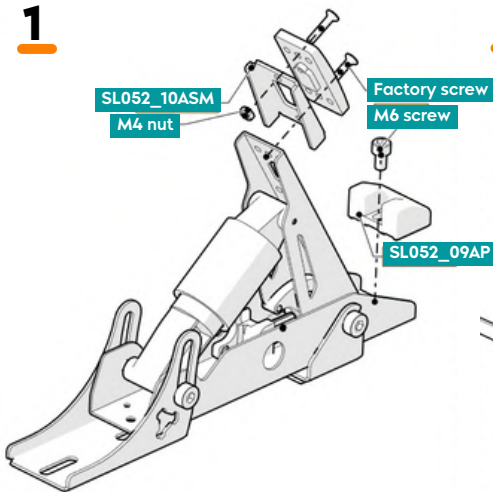

2

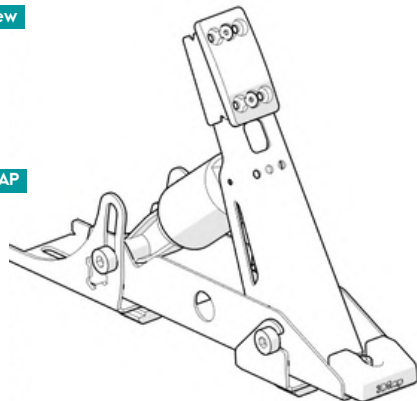

Pedals installation on generic base plate

3 x M6 hammer
nut



3xM6 socket
head cap screw

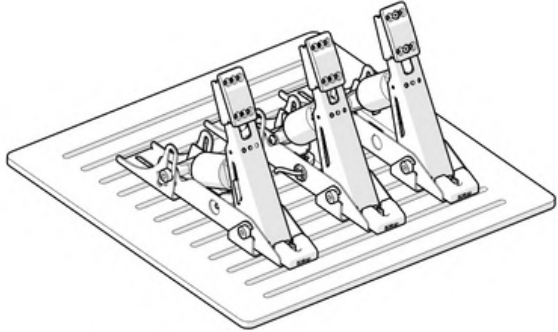

1

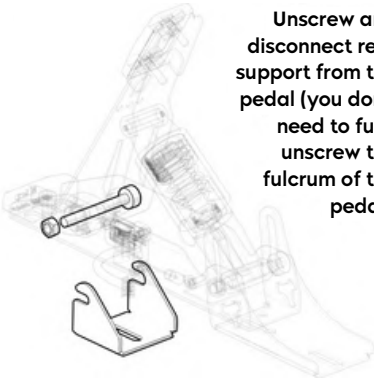

Unscrew and disconnect rear support from the pedal (you don't need to fully unscrew the fulcrum of the pedal).

2

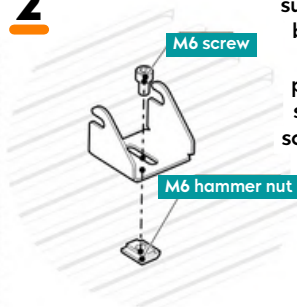

Place the rear support on the base plate at the chosen position, then screw the M6 screw with the nut to fix the support.

3



4

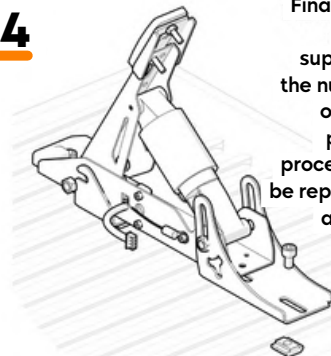

Finally, screw the front support with the nut to fix it on the base plate. The procedure can be repeated for all pedals.



Pedals installation on nGASa GT base

3 x M6 socket
head cap screw

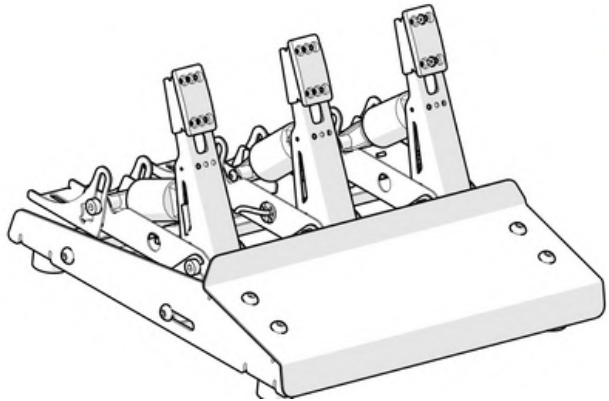
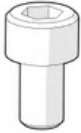

1

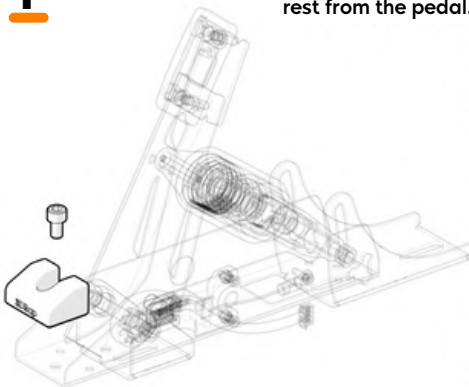

Remove the heel
rest from the pedal.

2

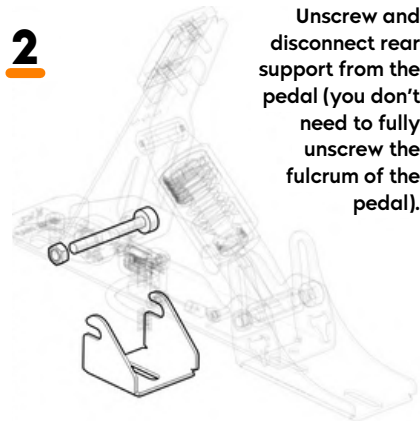

Unscrew and
disconnect rear
support from the
pedal (you don't
need to fully
unscrew the
fulcrum of the
pedal).

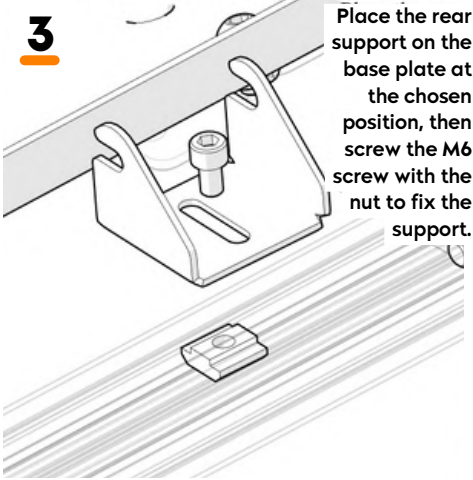

3

Place the rear support on the base plate at the chosen position, then screw the M6 screw with the nut to fix the support.

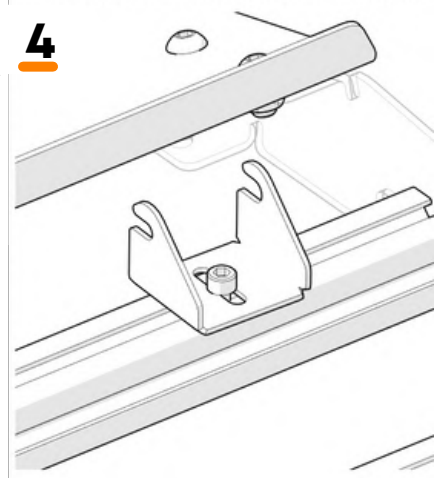

4

5

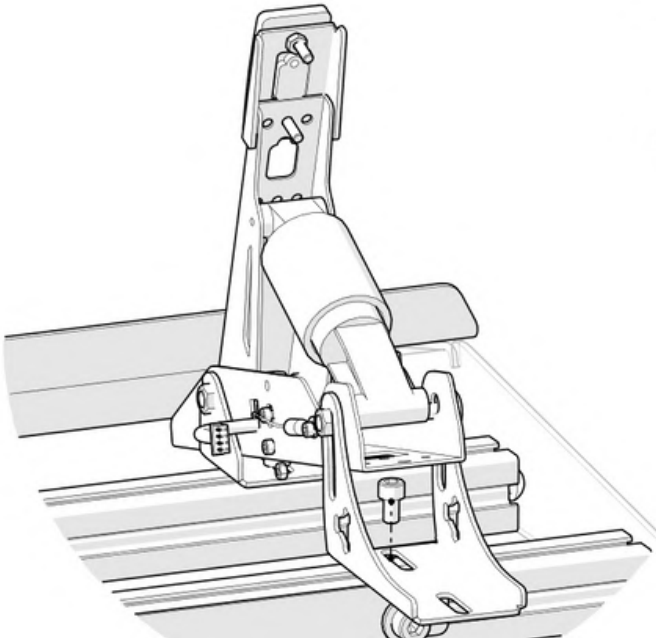

Finally, screw the front support with the nut to fix it on the base plate. The procedure can be repeated for all pedals.



3DRAP

SIM RACING EQUIPMENTS



3DRAP.IT